

 **KÄRCHER**

**5.960-549.0**

07/2006

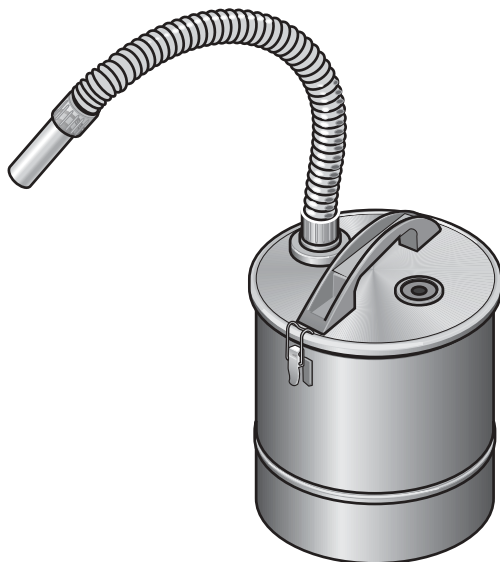

**Deutsch**  
**English**  
**Français**  
**Italiano**  
**Nederlands**  
**Español**  
**Português**  
**Dansk**  
**Norsk**  
**Svenska**  
**Suomi**  
**Ελληνικά**  
**Türkçe**  
**Русский**  
**Magyar**  
**Česky**  
**Slovensko**  
**Polski**  
**Românește**  
**Slovensky**  
**Hrvatski**  
**Srpski**  
**Български**  
**Eesti**  
**Latviešu**  
**Lietuviškai**



## Description of the Appliance

- 1 Container
- 2 Cover with carrying handle
- 3 Clip
- 4a Suction hose, ash filter
- 4b Suction tube
- 5 Connection for suction hose (bayonet fixing), ash filter
- 6 Connection for suction hose, vacuum cleaner

### not included in the scope of delivery

- 7 Suction hose, vacuum cleaner
- 8 Kärcher wet and dry vacuum cleaner

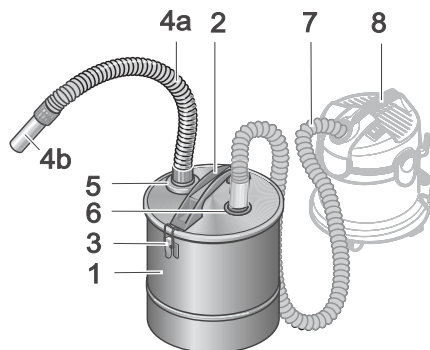

## Proper Use

In connection with a Kärcher wet and dry vacuum cleaner (not included in the scope of delivery), this ash filter is particularly suited for sweeping up ashes or vacuuming material from chimneys, oven, ashtrays, or grills.

Do **not** use the ash filter with dry vacuum cleaners or third-party devices.



## Safety Instructions

- **Please read the operating instructions of your device before using the appliance, and pay particular attention to the following safety instructions.**
- In addition to the information contained in the operating instructions, you must also comply with all statutory regulations and provisions with respect to safety and the prevention of accidents.
- The ash filter must **not** be used for the separation of hazardous substances.
- Do **not** vacuum up soot!
- Only vacuum up ashes of admissible combustibles!
- Do **not** vacuum up hot, burning, or red hot objects (e.g. cigarettes, charcoal, ashes, etc.). The temperature of the vacuuming material must be below 40°C.
- **Caution!** If the temperature of the vacuuming material exceeds 40°C, there is a risk of fire.

**Attention!** Vacuuming material which appears to have cooled down from the outside may still be very hot inside. Hot ash particles may ignite again in the air flow.



Wait in any case until the fire or the ash has cooled down before you begin with the cleaning. It is not recommended to quickly extinguish the fire with water. The cast iron components in the chimney do not bear the sudden variations in temperatures which may result in cracks.

- Please make sure that the oven is cold before you vacuum clean ovens. Temperatures exceeding 40°C may damage the vacuum cleaner and the ash filter.
- Continuously check tubes, ash filter, and vacuum cleaner for excessive temperatures during the vacuum cleaning.

If you notice a temperature rise, switch off the vacuum cleaner immediately. Disconnect the vacuum cleaner from the mains, and remove the filter bag. Remove the vacuuming material from the ash filter. Let both appliances (vacuum cleaner and ash filter) cool down under supervision.

**Caution!** In case of excessive temperatures, the tubes, the ash filter, or the vacuum cleaner may be damaged.

- Completely empty the vacuum cleaner and the ash filter after the vacuum cleaning.

**Caution!** Risk of fire in the vacuum cleaner

## Environmental Protection

### Please arrange for the proper disposal of the packaging

The packaging material can be recycled. Please do not place the packaging into the ordinary refuse for disposal, but arrange for the proper recycling.



### Please arrange for the proper disposal of the old appliance

Old appliances contain valuable materials that can be recycled. Please arrange for the proper recycling of old appliances. Batteries, oil, and similar substances must not enter the environment. Please dispose of your old appliances using appropriate collection systems.



## Installation and Operating Instructions

Check the contents of the box when unpacking the appliance. If you detect any transport damages, please contact your dealer.

- Take the ash filter out of the packaging.
- Open the clips (3), and remove the container cover (2).
- Take all parts out of the container, reinsert the container cover, and close it using the clips.
- Insert the suction tube (4b) on the end of the suction hose (4a). The two ends of the suction hose are identical.
- Insert the suction hose of the ash filter (4) into the appropriate connection (5), and turn it (bayonet fixing).

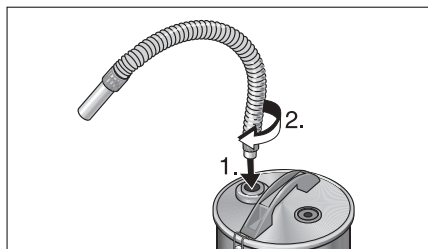

- Prepare the vacuum cleaner according to the operating instructions. Insert a filter bag in any case.

- Insert the suction hose of the vacuum cleaner (7) into the appropriate connection (6).
- Turn on the vacuum cleaner (8), and begin your work.

## Maintenance

- Completely empty the container of the ash filter after each use, and clean it with water. Then, let the container dry. **Never** use combustible substances for the cleaning!

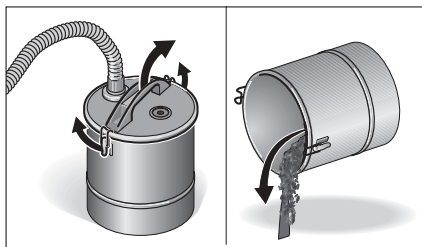

- Exchange the filter bag of the vacuum cleaner according to the operating instructions.

## Accessories and Spare Parts

Only use accessories and spare parts which have been approved by the manufacturer. The exclusive use of original accessories and original spare parts ensures that the appliance can be operated safely and troublefree.

## Warranty

The warranty terms published by our competent sales company are applicable in each country. We will repair potential failures of your appliance within the warranty period free of charge, provided that such failure is caused by faulty material or defects in fabrication. In the event of a warranty claim please contact your dealer or the nearest authorized Customer Service center. Please submit the proof of purchase.

## Specifications

Container capacity	20 l
Length of the suction hose	1 m
Nominal width of the metal suction tube	40 mm
Entire weight	3.7 kg

